

COLUMBUS
AWNING

Architectural Metals

HANGER ROD CANOPIES

For more information visit
columbusawningcompany.com



HANGER ROD CANOPY SYSTEMS

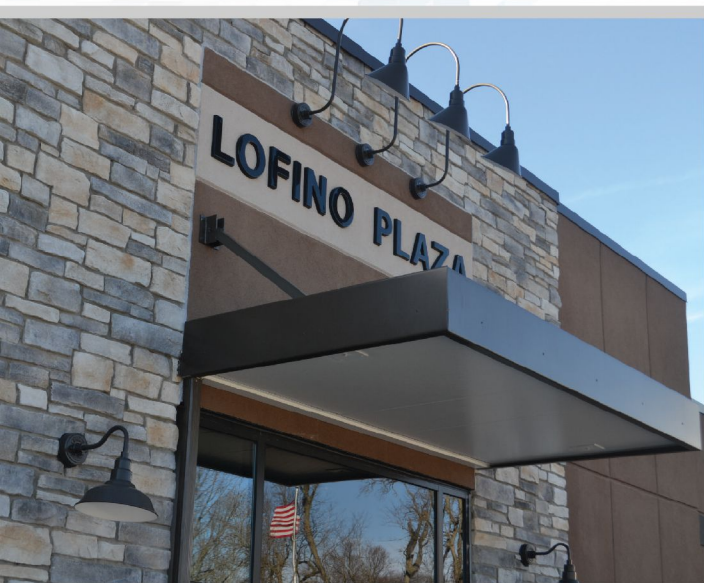

A FOUR SEASON CANOPY SOLUTION

The Columbus Awning canopy system is an all-extruded, pre-engineered canopy designed for a high-load architectural applications with optional decking and fascia options. The flat decking and square cap-pan deck options provide a long term, highly durable solution. The flat interlocking decking provides a smooth, sleek profile. The roll formed interlocking decking allows for a value engineered option while still maintaining load capacity and functionality. A variety of different fascia profiles and attachment methods provide a variety of design options to complete the building aesthetics. Compared to the alternatives, our fully welded aluminum gutter systems, non-rusting finish and high-quality extruded materials offer a complete turn-key solution to satisfy any budget and scope.

CANOPY HIGHLIGHTS

- FULLY WELDED 360 GUTTER FRAMES
- ALL EXTRUDED ALUMINUM
- CUSTOM DESIGN AND ENGINEERING AVAILABLE
- PROFESSIONAL DESIGN, COLOR AND FINISHES
- TURNKEY SOLUTIONS FOR MANUFACTURING AND INSTALLATION
- MAINTENANCE AND RUST FREE

TECHNICAL DATA

- Fascia .125"
- Flat Decking .081
- Roll Formed Decking .04"
- Deflection Rating L/180
- Maximum Projection
 - 5' with cantilevered supports
 - 10' or 8' depending on decking selection w/ hanger rod supports



COLUMBUS AWNING **Architectural Metals**

297 OLD COUNTY LINE RD, WESTERVILLE, OH 43081 PHONE: (614) 426-4206 COLUMBUSAWNINGCOMPANY.COM

HANGER ROD CANOPY SYSTEMS

DECKING OPTIONS



2 3/4" Cap and Pan
maximum projection 10'



Smooth Decking
maximum projection 8'



Rolled Form Interlock Decking
maximum projection 10'

FASCIA OPTIONS

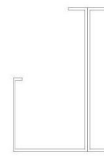
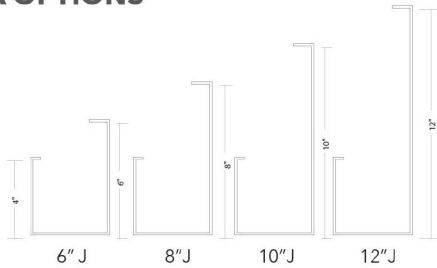

C Channel
available 8", 10", 12"
lip dimension made to request

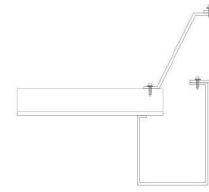

Custom Extensions

WALL MOUNT/ INSTALLATION

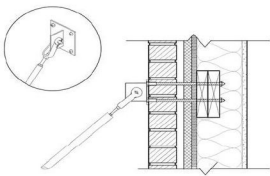

Brick/Block with thru bolts
and compression sleeves

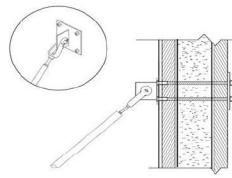

CMU with thru bolt

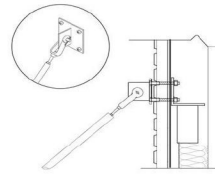

Metal building

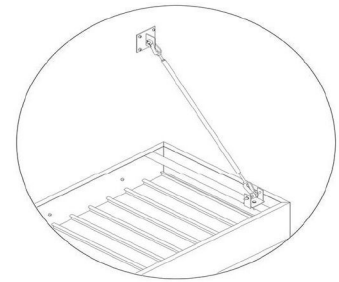

CLEVIS CONNECTIONS AND WALL BRACKETS

CLEVICES, CL2 (RIGHT AND LEFT)
ASTM A668, C-1035 Steel
3,500 LBS Capacity
1/2" UNC Thread

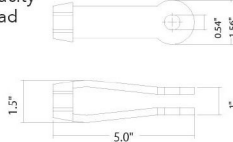

SADDLE BRACKETS
C - 1035 Steel
3/16 Thickness

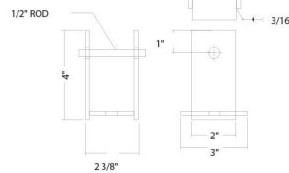

SURFACE WALL MOUNTING BRACKETS
C 1035 Steel
3,000 LBS Capacity

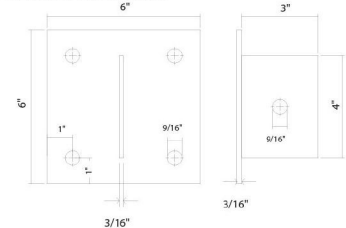

FINISH DETAILS

FINISH	DESCRIPTION	WARRANTY	SPECIFICATIONS	APPLICATION
Tiger Drylac Standard RAL	Standard RAL	1 year	Meets AAMA 2603 specifications	Factory applied
Superdurable Tiger Drylac2 Coat	Super Durable RAL Fishishes	10 year	Meets AAMA 2604 specifications	Professionally applied by approved finisher
Belbien or Reatec	Architectural Film	5 year	See finish details	Professionally applied by approved finisher