



# SUNSHADE CANOPIES

For more information visit  
[columbusawningcompany.com](http://columbusawningcompany.com)

# SUNSHADE CANOPY SYSTEMS



Columbus Awning Sunshade Louvers are some of the most versatile aluminum sunshade options available on the market. The passive sun control products can be used to manage the impact of solar gain on any building and integrate seamlessly with the design elements desired. The custom options deliver the most flexibility in the field to meet the aesthetic and budget required. Louvered types and sizes include airfoil blade, shutter blade, aluminum bar and tube, half tube or round. We offer a true custom design and turnkey solution to general contractors all over the U.S.

## CANOPY HIGHLIGHTS

- FULLY WELDED 360 FRAMES AND FASCIA OPTIONS
- ALL EXTRUDED ALUMINUM
- CUSTOM DESIGN AND ENGINEERING AVAILABLE
- PROFESSIONAL DESIGN, COLOR AND FINISHES
- TURNKEY SOLUTIONS FOR MANUFACTURING AND INSTALLATION
- MAINTENANCE AND RUST FREE

## TECHNICAL DATA

Fascia .125"  
Extruded Louvers range from .125" to .025"  
Deflection Rating L/180  
Maximum Projection:  
10' with hanger rod supports  
5' with cantilever supports

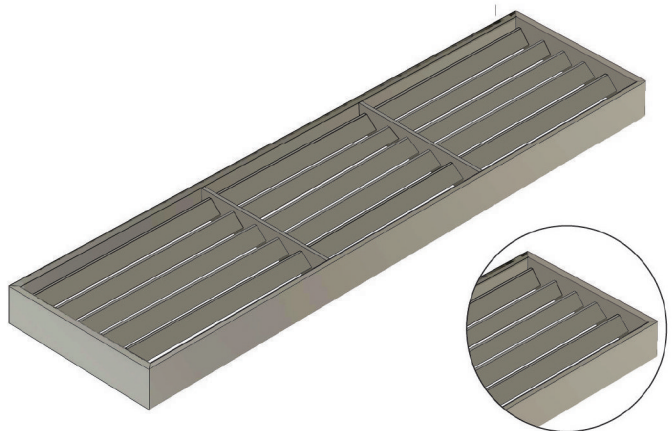

# SUNSHADE CANOPY SYSTEMS

## LOUVER OPTIONS All-extruded Aluminum (T6-6063)

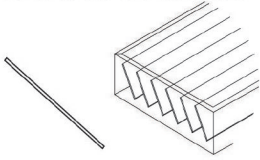

Flat Standard Louver Blade

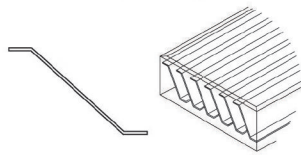

Z Louver Blade

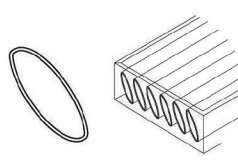

Airfoil Louver Blade

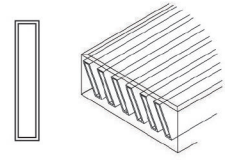

Tube Louver Blade

## FASCIA OPTIONS

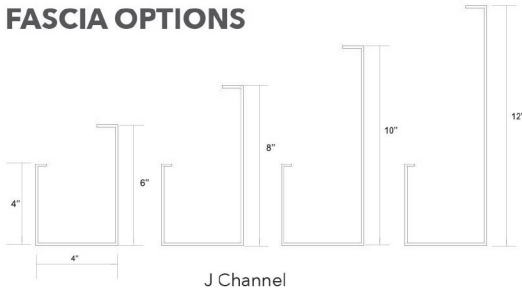

J Channel

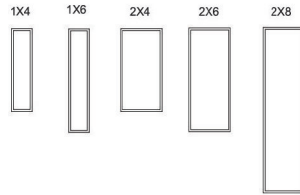

Rectangular Tube

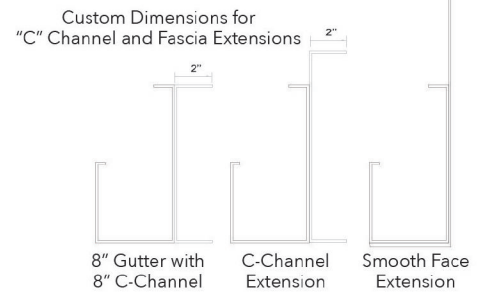

Custom Dimensions for "C" Channel and Fascia Extensions

8" Gutter with 8" C-Channel

C-Channel Extension

Smooth Face Extension

## ROUND, CURVED, BULL NOSE OPTIONS

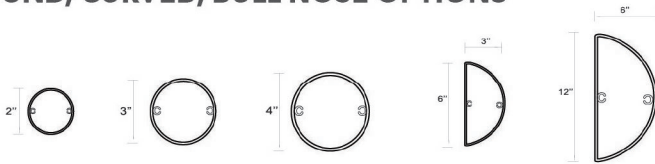

## OUTRIGGERS (Other Options Available)

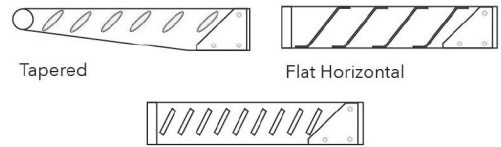

Tapered

Flat Horizontal

## MOUNTING OPTIONS

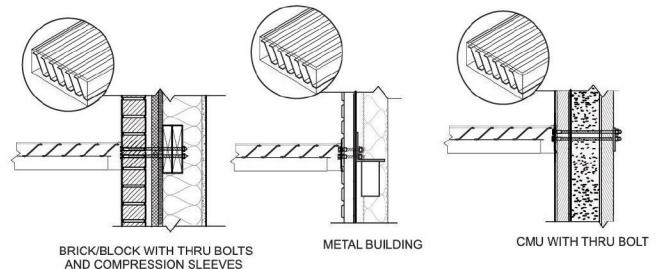
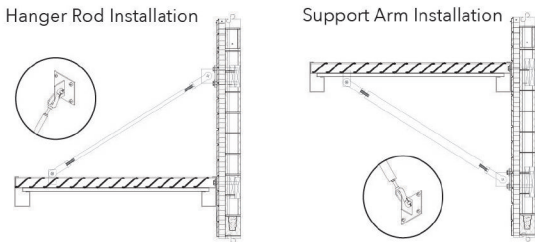

BRICK/BLOCK WITH THRU BOLTS AND COMPRESSION SLEEVES

METAL BUILDING

CMU WITH THRU BOLT

## FINISH DETAILS

FINISH	DESCRIPTION	WARRANTY	SPECIFICATIONS	APPLICATION
Tiger Drylac Standard RAL	Standard RAL	1 year	Meets AAMA 2603 specifications	Factory applied
Superdurable Tiger Drylac2 Coat	Super Durable RAL Fishishes	10 year	70% Fluoropolymer meets AAMA 2605 specifications	Professionally applied by approved finisher
Belbien or Reatec	Architectural Film	5 year	See finish details	Professionally applied by approved finisher