

4600

TREELINE
POST SUPPORTED
AND WALKWAY
CANOPIES

For more information visit
columbusawningcompany.com





POST SUPPORTED & WALKWAY CANOPY SYSTEMS



TREELINE Post Supported and Walkway Canopy Systems are designed to provide a high quality, pre-engineered economical solution for both free standing and wall mounted applications. Custom design and structural options meet local building codes for snow and wind load requirements. Free spans up to 20', dependent upon local codes and load requirements, provide excellent protection and desired water management. With a variety of decking and fascia options available, the design can accommodate a variety of budgets and building requirements. Compared to the alternatives, our aluminum gutter systems, no-rusting finish and high quality extruded materials offer a complete turnkey solution to satisfy any budget and scope.

CANOPY HIGHLIGHTS

- 360 GUTTER FRAMES AND OPTIONAL WATER MANAGEMENT SOLUTIONS
- ALL EXTRUDED ALUMINUM AND OPTIONAL STEEL FOR HIGH LOAD CAPACITY
- CUSTOM DESIGN AND ENGINEERING AVAILABLE
- PROFESSIONAL DESIGN, COLOR AND FINISHES
- TURNKEY SOLUTIONS FOR MANUFACTURING AND INSTALLATION
- MAINTENANCE AND RUST FREE

TECHNICAL DATA

Fascia .125"
Flat Decking .081
Roll Formed Decking .04"
Deflection Rating L/180

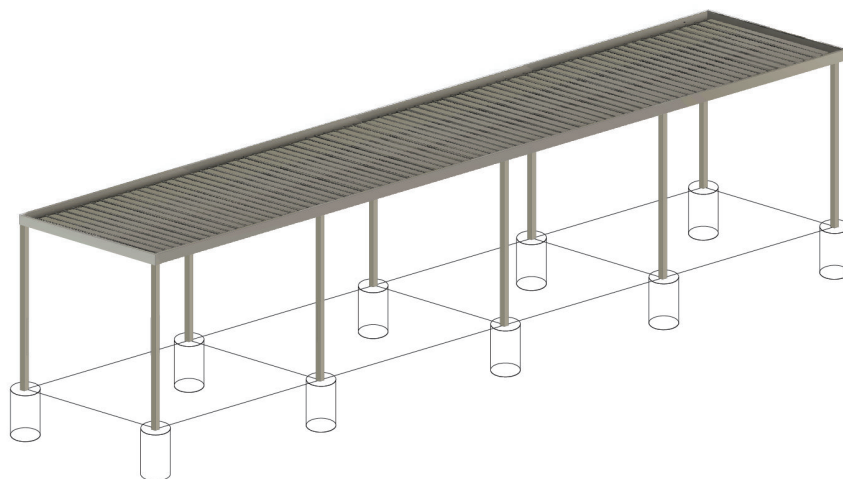

COLUMBUS AWNING **Architectural Metals**

297 OLD COUNTY LINE RD, WESTERVILLE, OH 43081 PHONE: (614) 426-4206 COLUMBUSAWNINGCOMPANY.COM



POST SUPPORTED & WALKWAY CANOPY SYSTEMS

DECKING OPTIONS

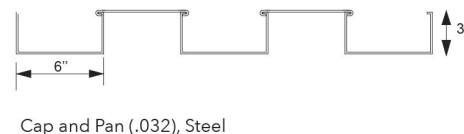
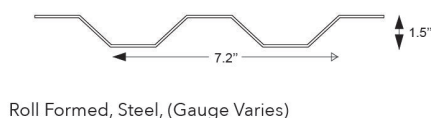

FASCIA OPTIONS

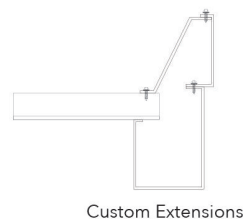
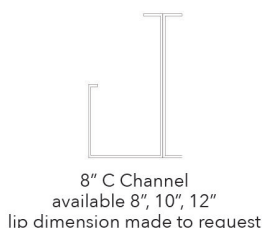
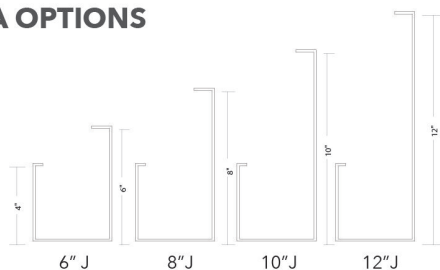

POST ATTACHMENT DETAILS AND OPTIONS

INGROUND FOOTING - FOAM BLOCK OUT

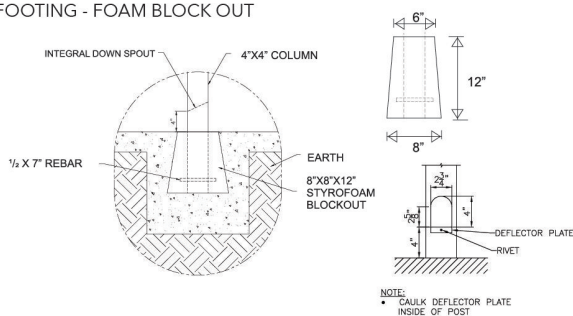

SURFACE ANCHOR

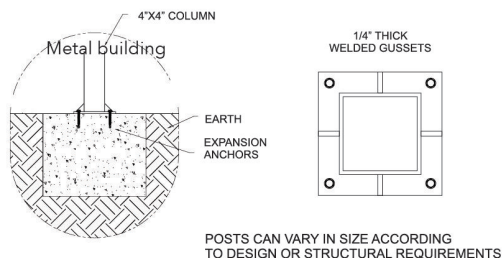

GUTTER BEAM AND DRAINAGE OPTIONS

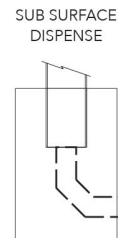
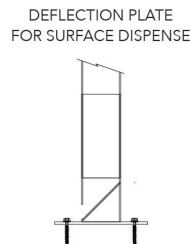
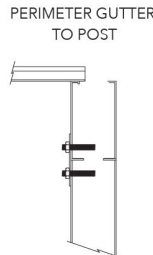
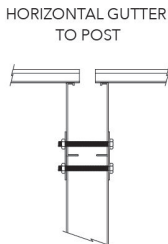
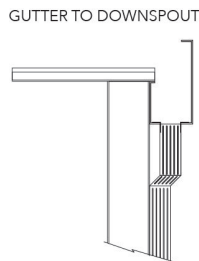

FINISH	DESCRIPTION	WARRANTY	SPECIFICATIONS	APPLICATION
Tiger Drylac Standard RAL	Standard RAL	1 year	Meets AAMA 2603 specifications	Factory applied
Superdurable Tiger Drylac2 Coat	Super Durable RAL Fishishes	10 year	70% Fluoropolymer meets AAMA 2605 specifications	Professionally applied by approved finisher
Belbien or Reatec	Architectural Film	5 year	See finish details	Professionally applied by approved finisher