

# **COLUMBUS AWNING WALKWAY CANOPY SYSTEM**

- ▲ Elevation Plan
- ▲ Cross Section
- ▲ Fascia / Decking
- ▲ Gutter Fascias
- ▲ Components
- ▲ Wall Attachments

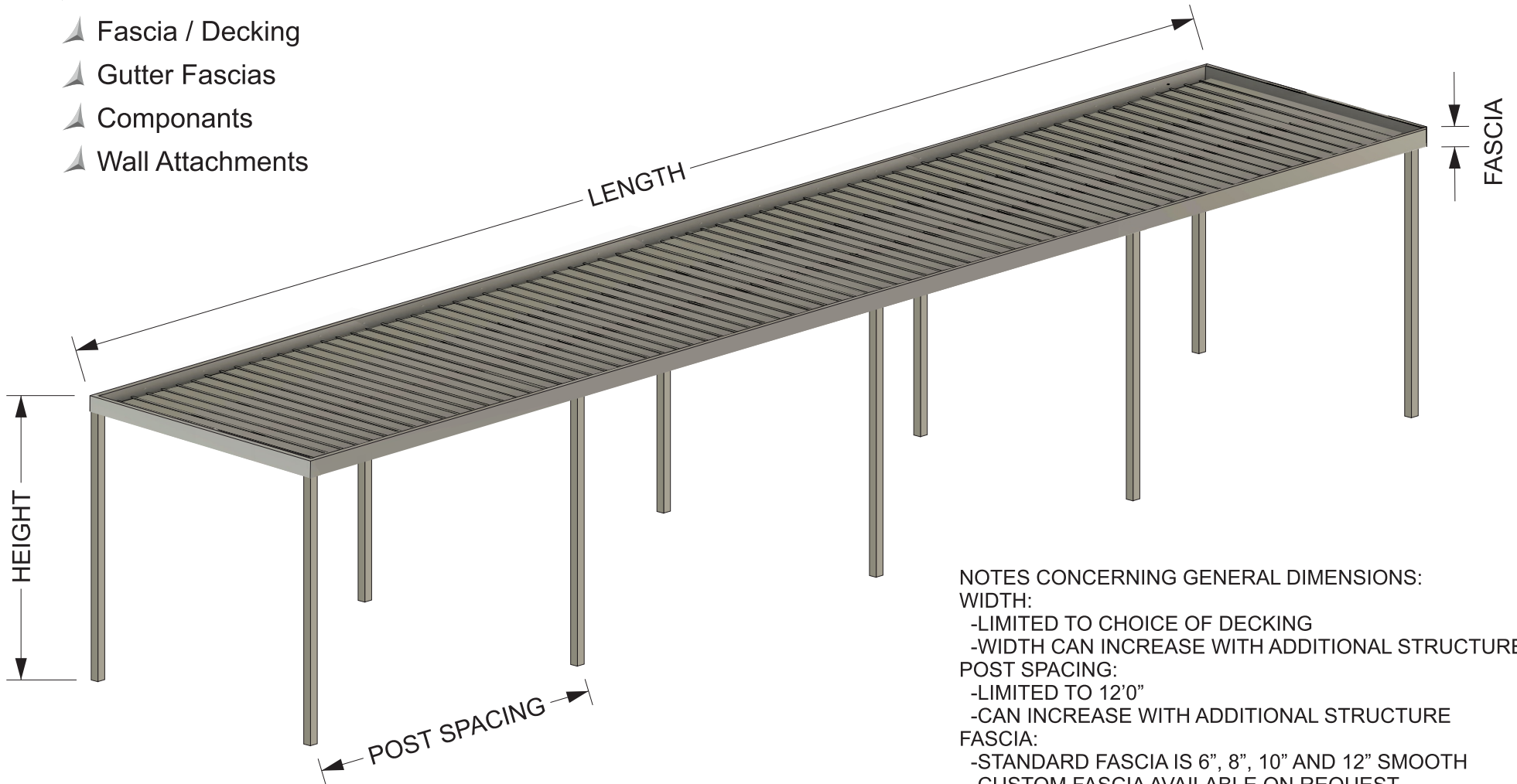

NOTES CONCERNING GENERAL DIMENSIONS:

WIDTH:

- LIMITED TO CHOICE OF DECKING
- WIDTH CAN INCREASE WITH ADDITIONAL STRUCTURE

POST SPACING:

- LIMITED TO 12'0"
- CAN INCREASE WITH ADDITIONAL STRUCTURE

FASCIA:

- STANDARD FASCIA IS 6", 8", 10" AND 12" SMOOTH
- CUSTOM FASCIA AVAILABLE ON REQUEST

PROJECT: \_\_\_\_\_  
 LOCATION: \_\_\_\_\_  
 PROJECT MANAGER: \_\_\_\_\_  
 PROPOSED: \_\_\_\_\_

DATE: \_\_\_\_\_  
 DESIGNER: \_\_\_\_\_  
 ENGINEER: \_\_\_\_\_  
 FILE FOLDER: \_\_\_\_\_  
 PAGE OF \_\_\_\_\_

CANOPY TYPE DETAILS

\_\_\_\_\_  
 \_\_\_\_\_  
 \_\_\_\_\_  
 \_\_\_\_\_

APPROVED ☐  
 APPROVED WITH CORRECTIONS ☐  
 NOT APPROVED RESUBMIT ☐

SIGNATURE: \_\_\_\_\_

# **POST SUPPORTED WALKWAY CANOPY (HORIZONTAL GUTTER BEAM)**

PLAN VIEW

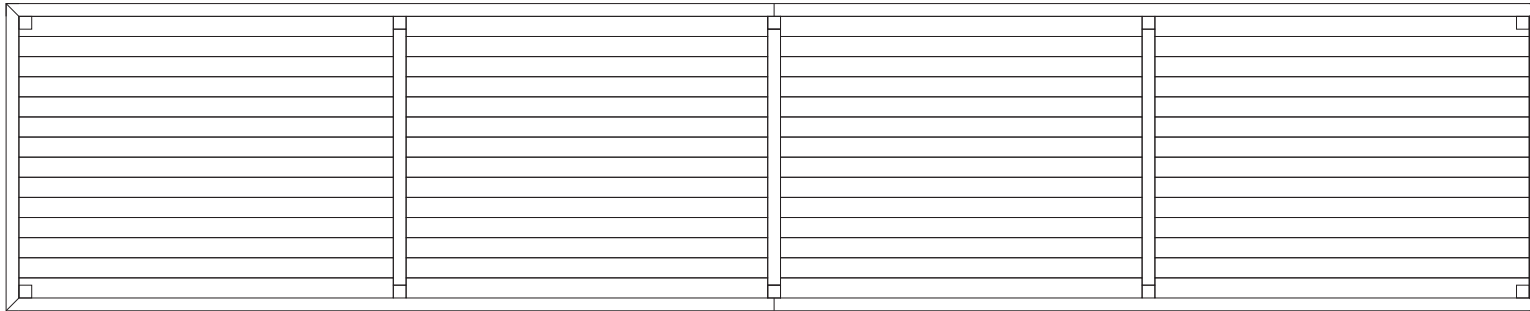

SIDE ELEVATION VIEW

GUTTER BEAM SPLITS

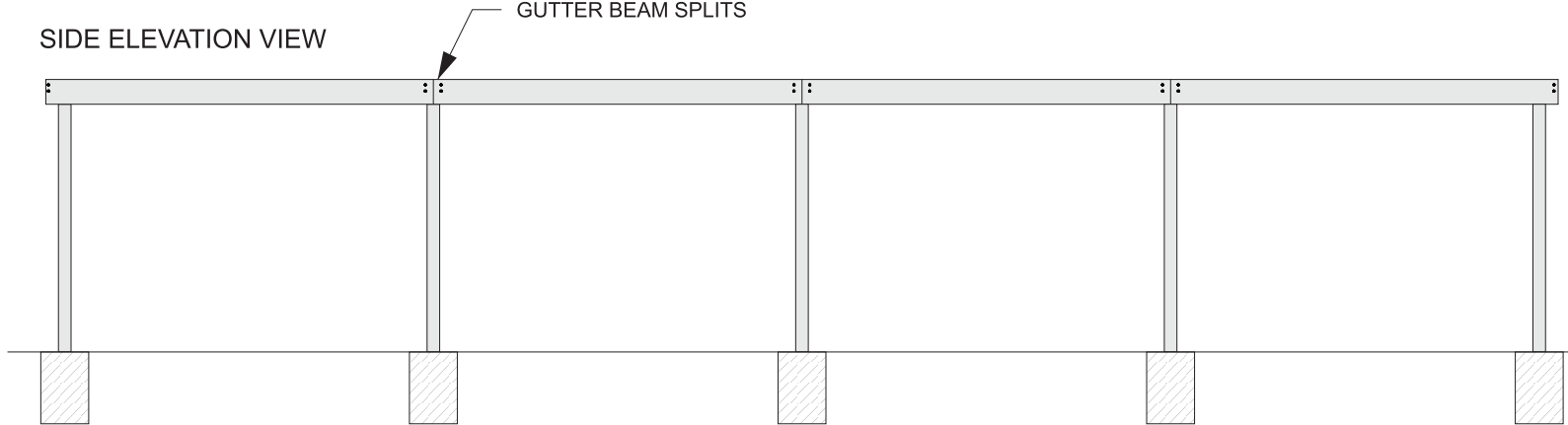

FRONT ELEVATION

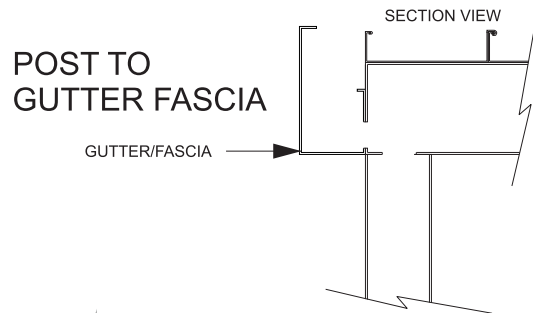
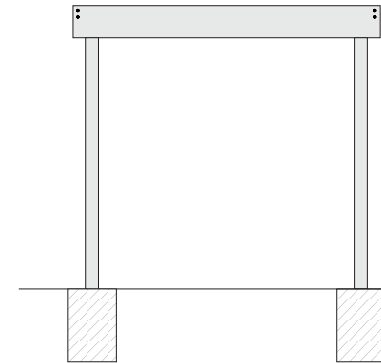

GUTTER/FASCIA SPLIT

SECTION VIEW

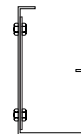

SECTION VIEW

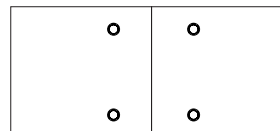

GUTTER BEAM TO POST

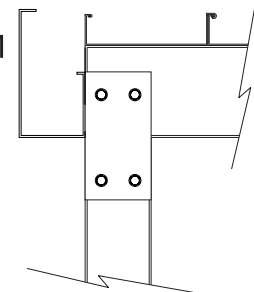

PROJECT: \_\_\_\_\_  
LOCATION: \_\_\_\_\_  
  
PROJECT MANAGER: \_\_\_\_\_  
PROPOSED: \_\_\_\_\_

DATE: \_\_\_\_\_  
DESIGNER: \_\_\_\_\_  
ENGINEER: \_\_\_\_\_  
FILE FOLDER: \_\_\_\_\_  
PAGE OF \_\_\_\_\_

CANOPY TYPE DETAILS

\_\_\_\_\_  
\_\_\_\_\_  
\_\_\_\_\_  
\_\_\_\_\_

APPROVED ☐  
APPROVED WITH CORRECTIONS ☐  
NOT APPROVED RESUBMIT ☐

SIGNATURE: \_\_\_\_\_

# WALKWAY CANOPY WITH GUTTER BEAMS

PLAN VIEW

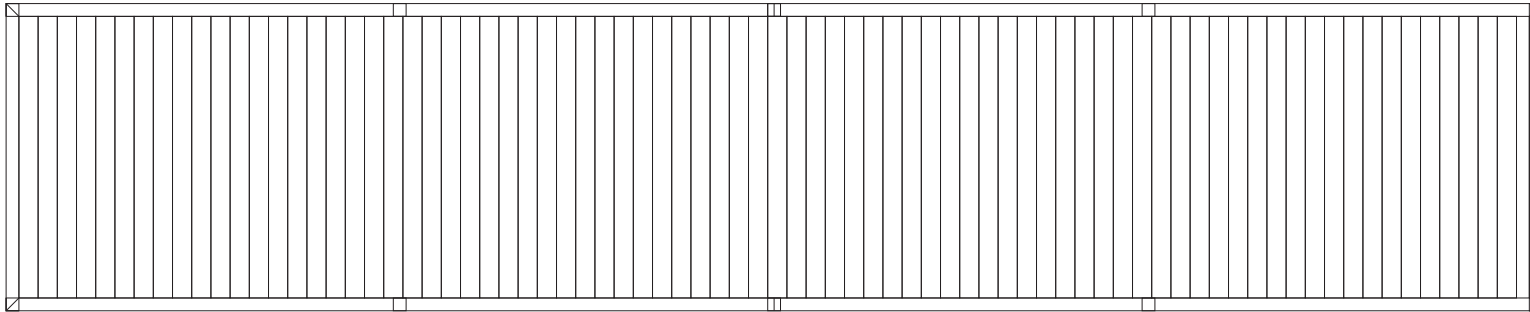

SIDE ELEVATION VIEW

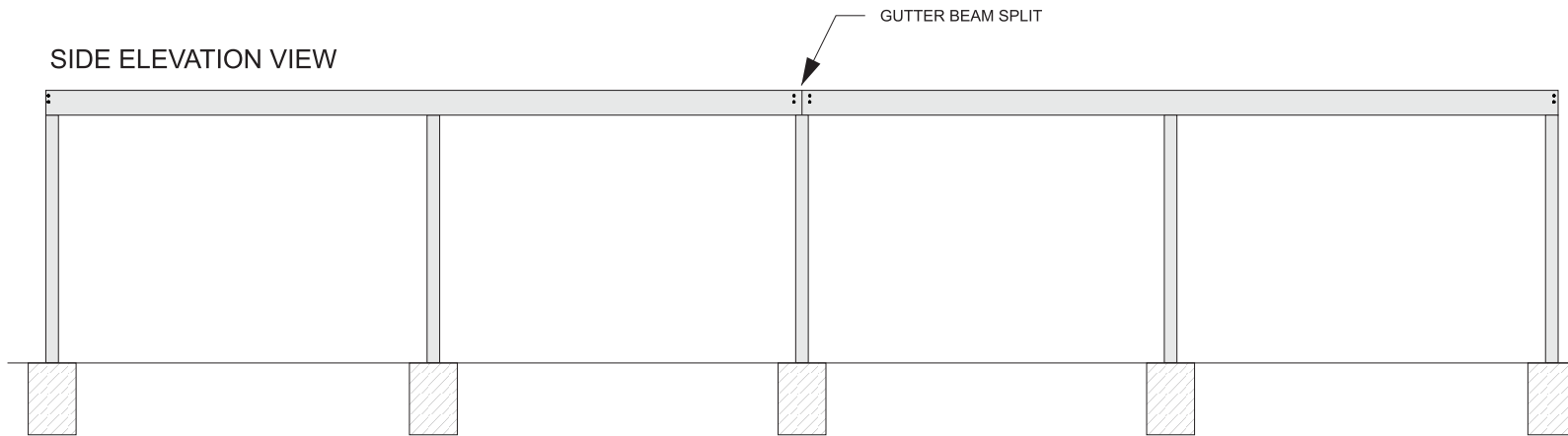

FRONT ELEVATION

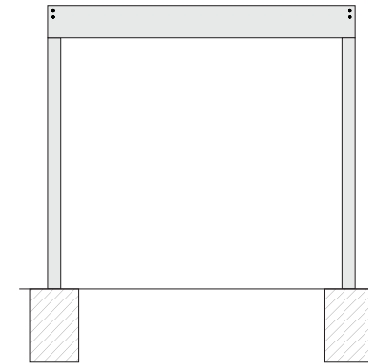

POST TO BEAM

SECTION VIEW

GUTTER/FASCIA

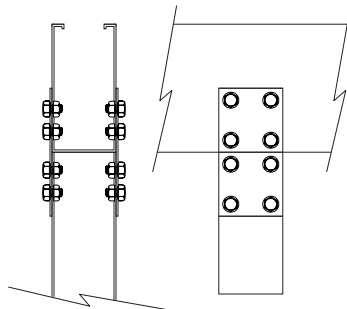

GUTTER BEAM SPLITS

SECTION VIEW

ELEVATION VIEW

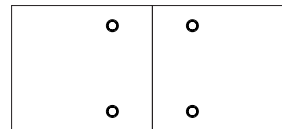
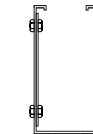

PROJECT: \_\_\_\_\_  
LOCATION: \_\_\_\_\_  
  
PROJECT MANAGER: \_\_\_\_\_  
PROPOSED: \_\_\_\_\_

DATE: \_\_\_\_\_  
DESIGNER: \_\_\_\_\_  
ENGINEER: \_\_\_\_\_  
FILE FOLDER: \_\_\_\_\_  
PAGE OF \_\_\_\_\_

CANOPY TYPE DETAILS

\_\_\_\_\_  
\_\_\_\_\_  
\_\_\_\_\_  
\_\_\_\_\_

APPROVED ☐  
APPROVED WITH CORRECTIONS ☐  
NOT APPROVED RESUBMIT ☐

SIGNATURE: \_\_\_\_\_

# WALL AND POST SUPPORTED WALKWAY CANOPY

PLAN VIEW

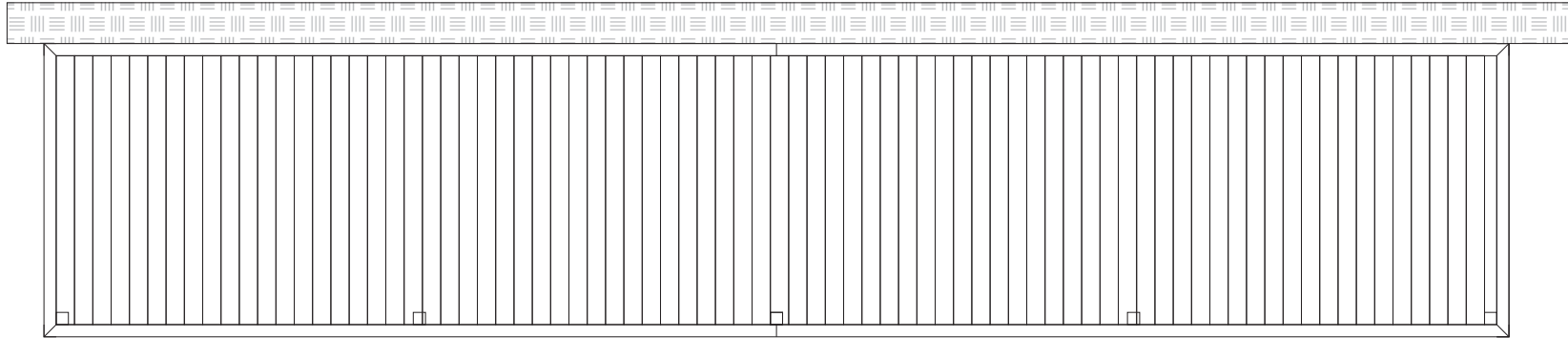

SIDE ELEVATION VIEW

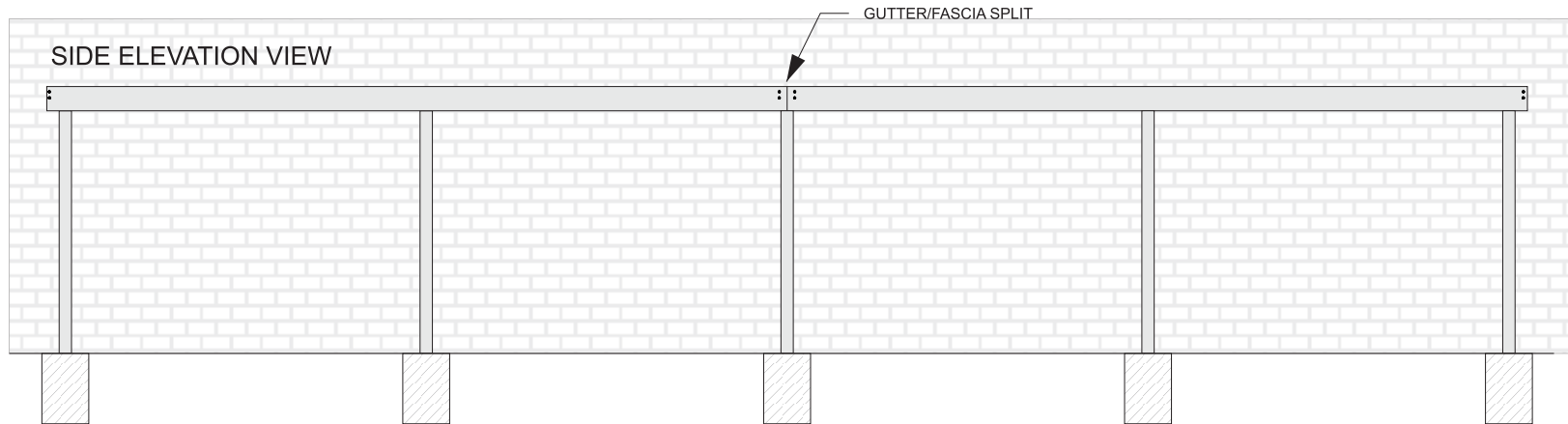

FRONT ELEVATION

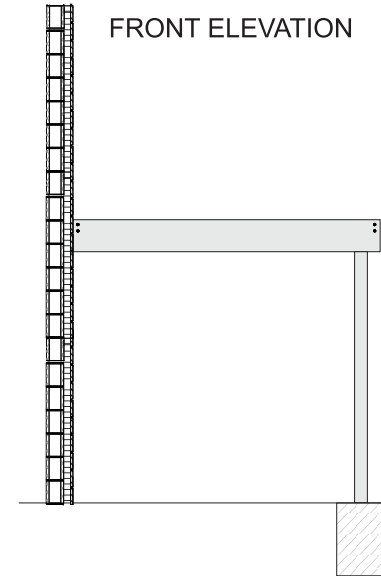

POST TO FRAME

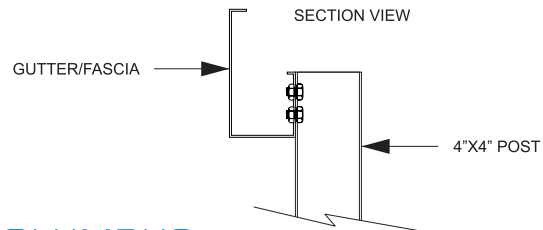

GUTTER/FASCIA SPLIT

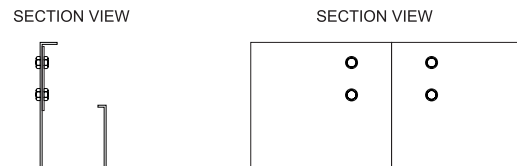

297 OLD COUNTY LINE RD  
WESTERVILLE, OHIO  
43081



614-426-4206

www.columbusawningcompany.com

PROJECT: \_\_\_\_\_  
LOCATION: \_\_\_\_\_  
  
PROJECT MANAGER: \_\_\_\_\_  
PROPOSED: \_\_\_\_\_

DATE: \_\_\_\_\_  
DESIGNER: \_\_\_\_\_  
ENGINEER: \_\_\_\_\_  
FILE FOLDER: \_\_\_\_\_  
PAGE OF \_\_\_\_\_

CANOPY TYPE DETAILS

\_\_\_\_\_  
\_\_\_\_\_  
\_\_\_\_\_  
\_\_\_\_\_

APPROVED ☐  
APPROVED WITH CORRECTIONS ☐  
NOT APPROVED RESUBMIT ☐

SIGNATURE: \_\_\_\_\_



# DECKING TO GUTTER FASCIA CROSS SECTIONS

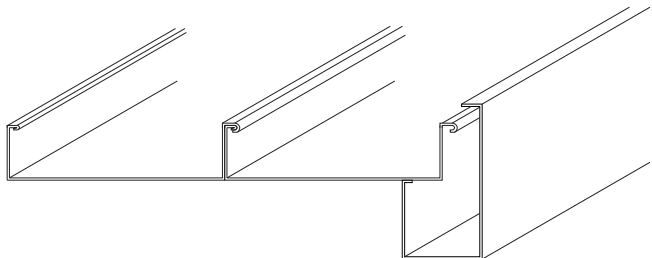
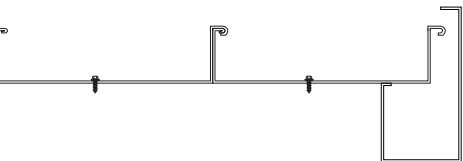
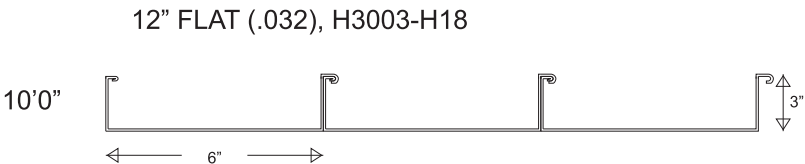
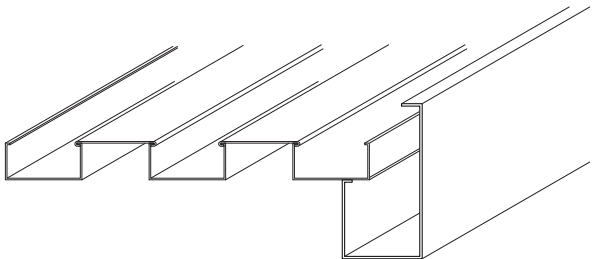
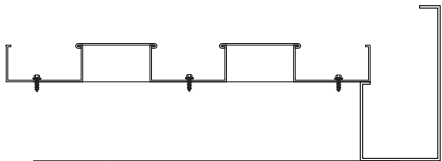
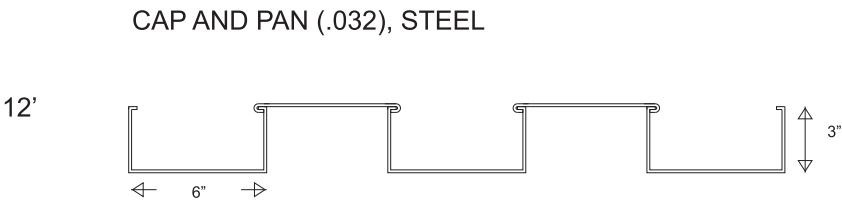
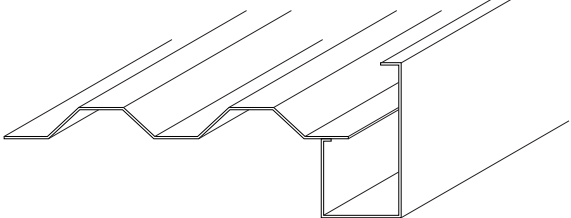
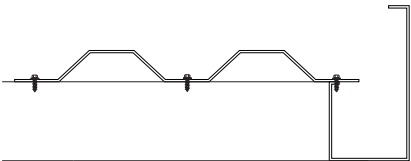
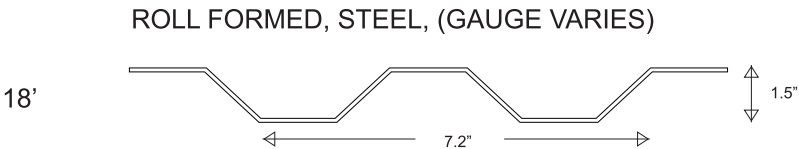
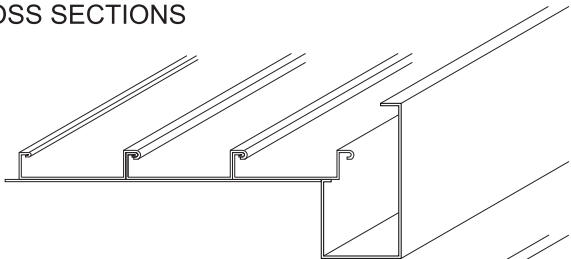
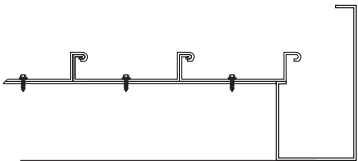
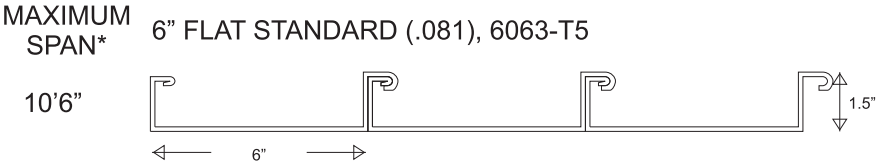

\* Spans exceeding the allowable distance can be achieved through additional structures.  
Columbus Awning develops engineering solutions to meet the customer's needs.  
Performance requirements vary according to State and Local codes

OTHER MATERIAL FOR DECKING IS AVAILABLE ON REQUEST:

- ▲ PLEXIGLASS
- ▲ WOOD
- ▲ OTHERS

PROJECT: LOCATION:	DATE: DESIGNER: ENGINEER: FILE FOLDER: PAGE OF	CANOPY TYPE DETAILS	APPROVED <input type="checkbox"/> APPROVED WITH CORRECTIONS <input type="checkbox"/> NOT APPROVED RESUBMIT <input type="checkbox"/> SIGNATURE: _____
PROJECT MANAGER: PROPOSED:			

## STRUCTURAL COMPONENTS

6063 T5 ALUMINUM  
0.125" WALL THICKNESS

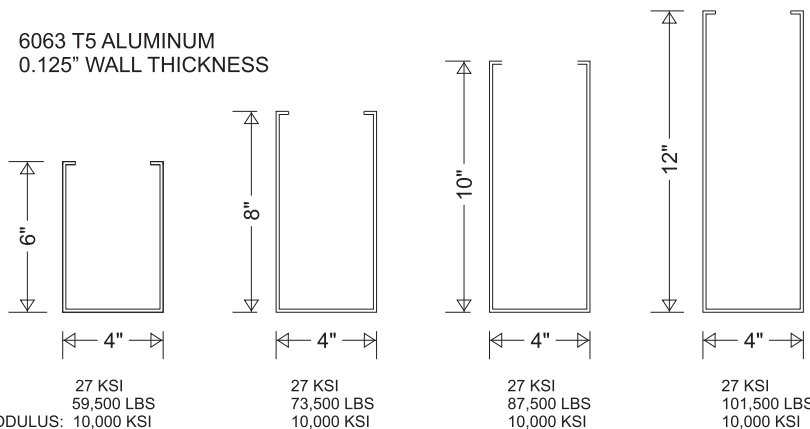

POSTS 6063 T6 ALUMINUM  
-OR-  
A500 GRADE B STEEL

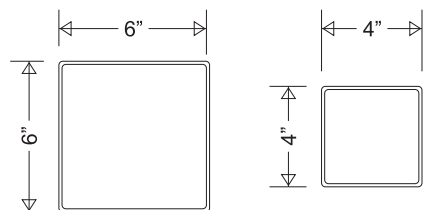

ALUMINUM UTS: 28 KSI  
YIELD: 252,000 LBS  
YOUNGS MODULUS: 11,200 KSI

28 KSI  
112,500 LBS  
9,110 KSI

STEEL UTS: 58 KSI  
YIELD: 522,000 LBS  
YOUNGS MODULUS: 11,200 KSI

58 KSI  
232,000 LBS  
9,110 KSI

## SPLICING PIECES

\* USED WITH SEALER

6063 T6 ALUMINUM  
0.125" WALL THICKNESS

GUTTER SPLICE

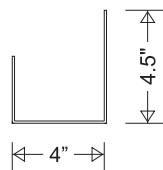

GUTTER BEAM  
SPLICE

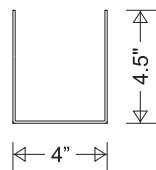

## GUTTER/FASCIA

MATERIAL: 6063-T6 ALUMINUM  
ULTIMATE TENSILE STRENGTH: 28KSI  
THICKNESS: 0.125"

C CHANNEL

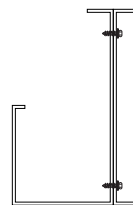

FASCIA EXTENSION

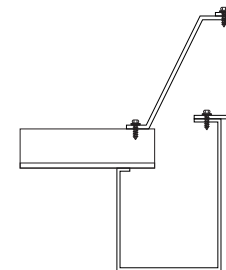

CUSTOM DIMENSIONS FOR  
"C" CHANNEL AND FASCIA EXTENSIONS  
COLUMBUS AWNING FABRICS  
CUSTOM FASCIA  
AND ATTACHES TO GUTTER/FASCIA

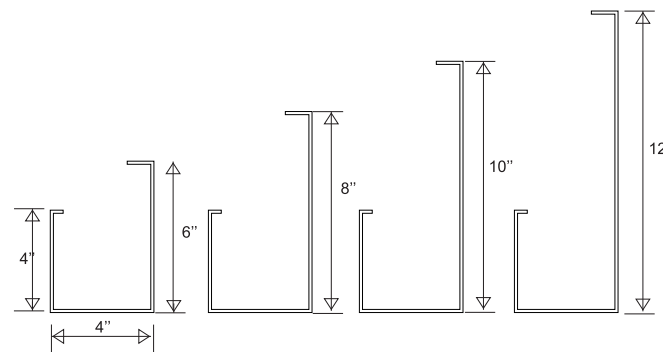

STANDARD FASCIA SHOWN  
CUSTOM FASCIA CAN BE FABRICATED BY COLUMBUS AWNING

PROJECT: \_\_\_\_\_  
LOCATION: \_\_\_\_\_  
  
PROJECT MANAGER: \_\_\_\_\_  
PROPOSED: \_\_\_\_\_

DATE: \_\_\_\_\_  
DESIGNER: \_\_\_\_\_  
ENGINEER: \_\_\_\_\_  
FILE FOLDER: \_\_\_\_\_  
PAGE OF \_\_\_\_\_

CANOPY TYPE DETAILS

\_\_\_\_\_  
\_\_\_\_\_  
\_\_\_\_\_  
\_\_\_\_\_

APPROVED ☐  
APPROVED WITH CORRECTIONS ☐  
NOT APPROVED RESUBMIT ☐

SIGNATURE: \_\_\_\_\_

## WALL ATTACHMENTS

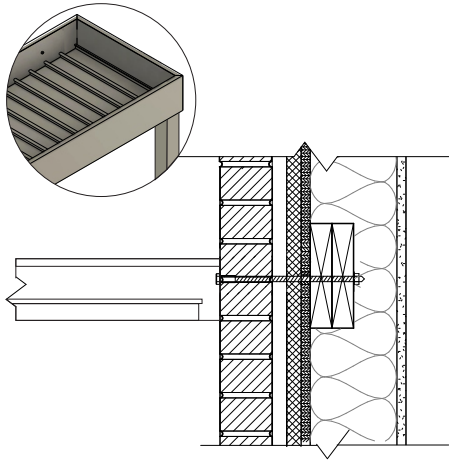

BRICK/BLOCK WITH THRU BOLTS  
AND COMPRESSION SLEEVES

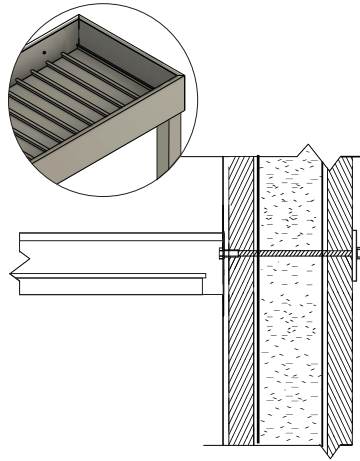

CMU WITH THRU BOLT

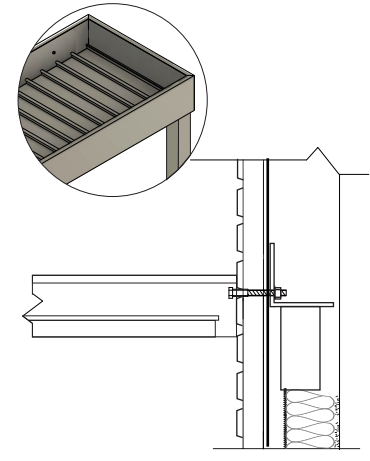

METAL BUILDING

## POST ANCHOR

### FOAM BLOCK OUT

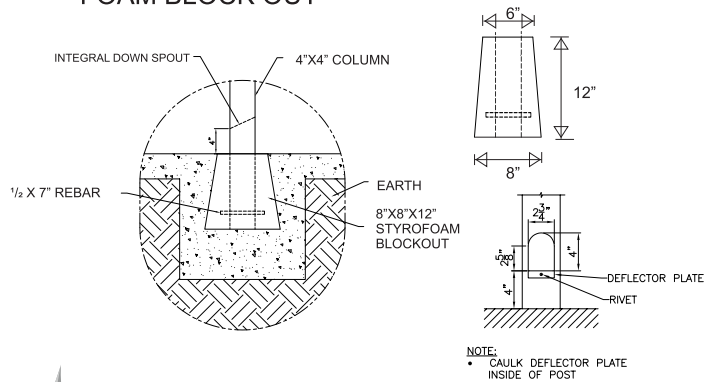

### SURFACE ANCHOR

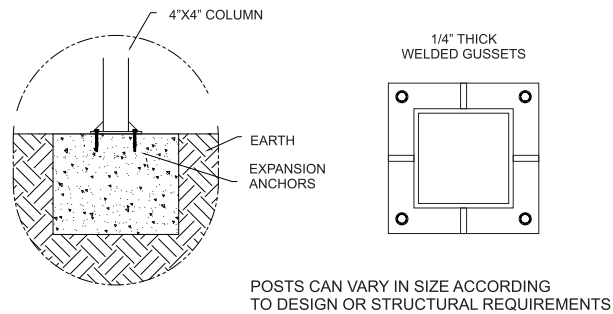

PROJECT: \_\_\_\_\_  
LOCATION: \_\_\_\_\_  
  
PROJECT MANAGER: \_\_\_\_\_  
PROPOSED: \_\_\_\_\_

DATE: \_\_\_\_\_  
DESIGNER: \_\_\_\_\_  
ENGINEER: \_\_\_\_\_  
FILE FOLDER: \_\_\_\_\_  
PAGE OF \_\_\_\_\_

### CANOPY TYPE DETAILS

\_\_\_\_\_  
\_\_\_\_\_  
\_\_\_\_\_  
\_\_\_\_\_

APPROVED ☐  
APPROVED WITH CORRECTIONS ☐  
NOT APPROVED RESUBMIT ☐

SIGNATURE: \_\_\_\_\_

GUTTER TO POST

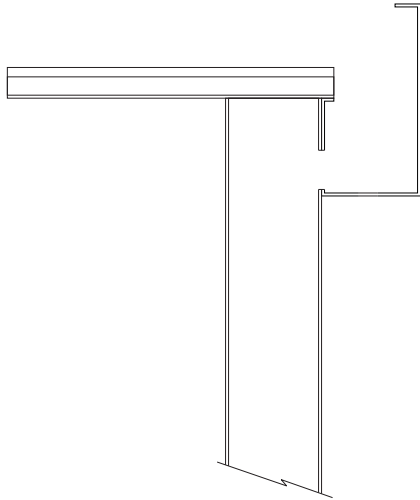

GUTTER TO DOWNSPOUT

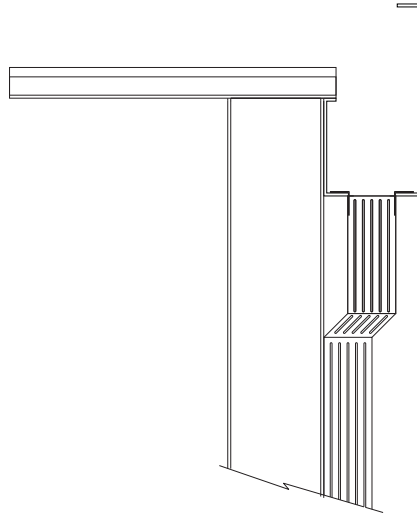

HORIZONTAL GUTTER BEAM  
TO POST

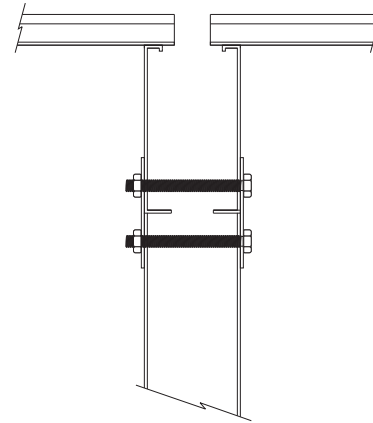

PERIMETER GUTTER BEAM  
TO POST

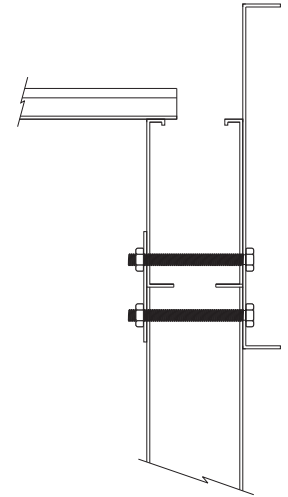

DEFLECTION PLATE  
FOR SURFACE DISPENSE

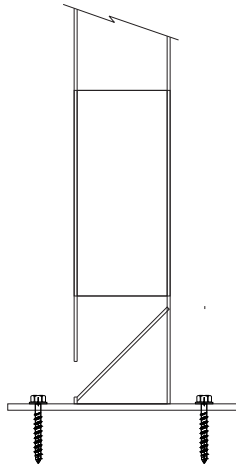

SUB SURFACE  
DISPENSE

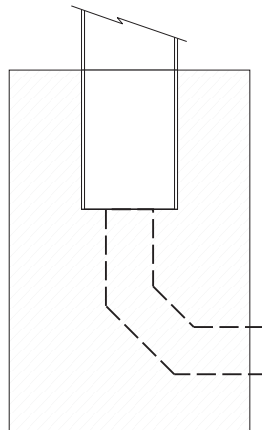

PROJECT:  
LOCATION:  
  
PROJECT MANAGER:  
PROPOSED:

DATE:  
DESIGNER:  
ENGINEER:  
FILE FOLDER:  
PAGE OF

CANOPY TYPE DETAILS

APPROVED ☐  
APPROVED WITH CORRECTIONS ☐  
NOT APPROVED RESUBMIT ☐

SIGNATURE: \_\_\_\_\_